

PART NUMBER	DESCRIPTION	MATERIAL
FP-HFL-213	SHIELD SUPPORT, MIDDLE, HYDRA FLKR.	1/4" HRS

REV.	DESCRIPTION	DATE	APPROVED
B	UPDATED HOLE TO 3/8" IN INSTEAD OF 13/16"	2/6/2012	

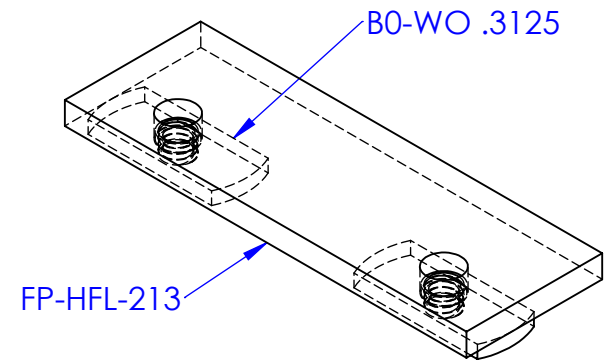

HFL-213 ASSEMBLY

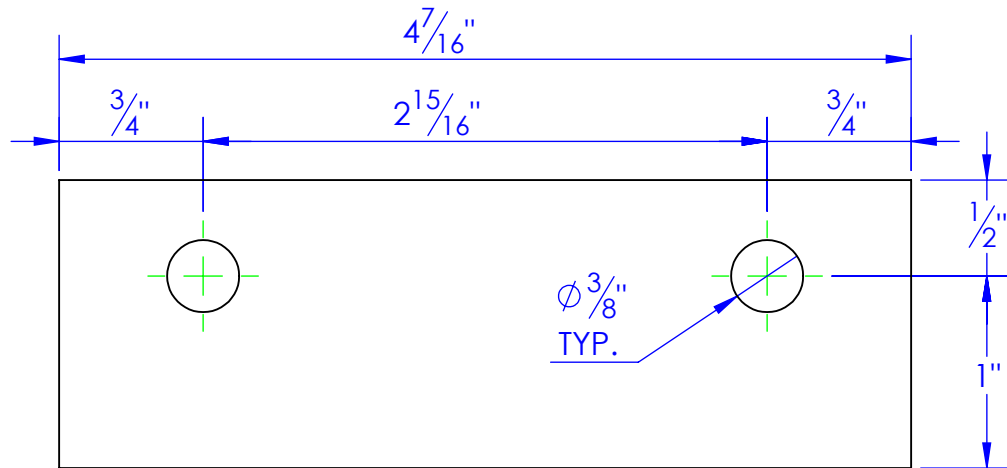
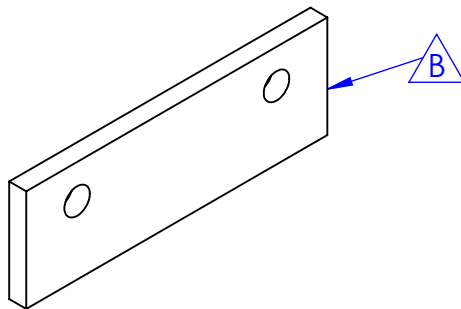
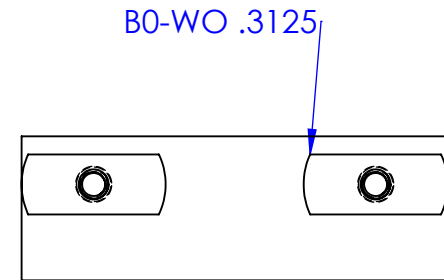
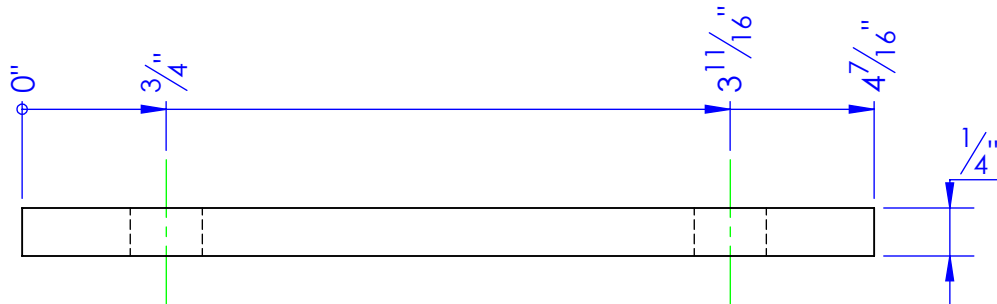

PROPRIETARY AND CONFIDENTIAL
THE INFORMATION CONTAINED IN THIS
DRAWING IS THE SOLE PROPERTY OF TRIPLE
C INC. ANY REPRODUCTION IN PART OR
AS A WHOLE WITHOUT THE WRITTEN
PERMISSION OF TRIPLE C INC. IS PROHIBITED.

DIMENSIONS ARE IN INCHES
TOLERANCES:
FRACTIONAL $\pm 1/16$
ANGULAR: MACH ± 1 BEND \pm
TWO PLACE DECIMAL ± 010
THREE PLACE DECIMAL ± 005

MATERIAL 1/4" HRS
DO NOT SCALE DRAWING

NAME	DATE
DRAWN HEATH	6/5/2012
PART #	FP-HFL-213
ASM #	
COMMENTS:	
SHIELD SUPPORT, MIDDLE, HYDRA FLKR.	

P.O. BOX 248,
SABETHA, KS 66534

TRIPLE C
INC.

SIZE	DWG. NO.	REV.
A	40-1212 B	B
SCALE: 1:1	WEIGHT: 0.46 LBS.	SHEET 1 OF 1